

# EXTENDED BODY GATE VALVES

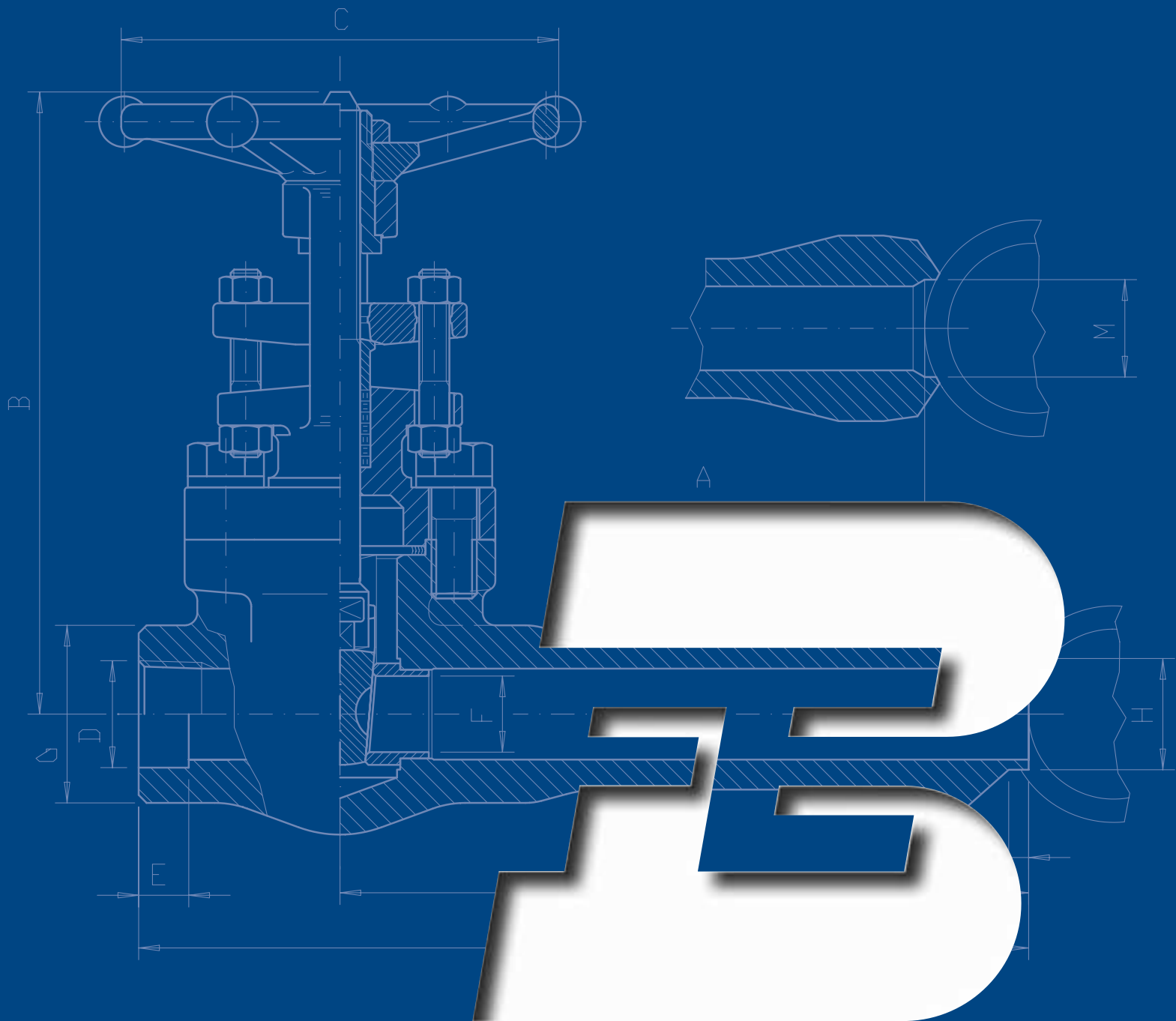

# EXTENDED BODY GATE VALVES

## VALV-O-LET

CLASS	FIGURE	
	Bolted Bonnet	Welded Bonnet
800	VL 100	VOL 100
1500	9VL 100	9VOL 100

## INTEGRAL REINFORCED

CLASS	FIGURE	
	Bolted Bonnet	Welded Bonnet
800	VLL 100	VOLL 100
1500	9VLL 100	9VOLL 100

## SOCKET WELD

CLASS	FIGURE	
	Bolted Bonnet	Welded Bonnet
800	MLT 100	MFLT 100
1500	9MLT 100	9MFLT 100

## BEVELED FOR WELDING

CLASS	FIGURE	
	Bolted Bonnet	Welded Bonnet
800	MLB 100	MFLB 100
1500	9MLB 100	9MFLB 100

## THREADED END

CLASS	FIGURE	
	Bolted Bonnet	Welded Bonnet
800	MLF 100	MFLF 100
1500	9MLF 100	9MFLF 100

# EXTENDED BODY GATE VALVES

**CLASS 800-1500**

**BOLTED BONNET/WELDED BONNET - Reduced bore**

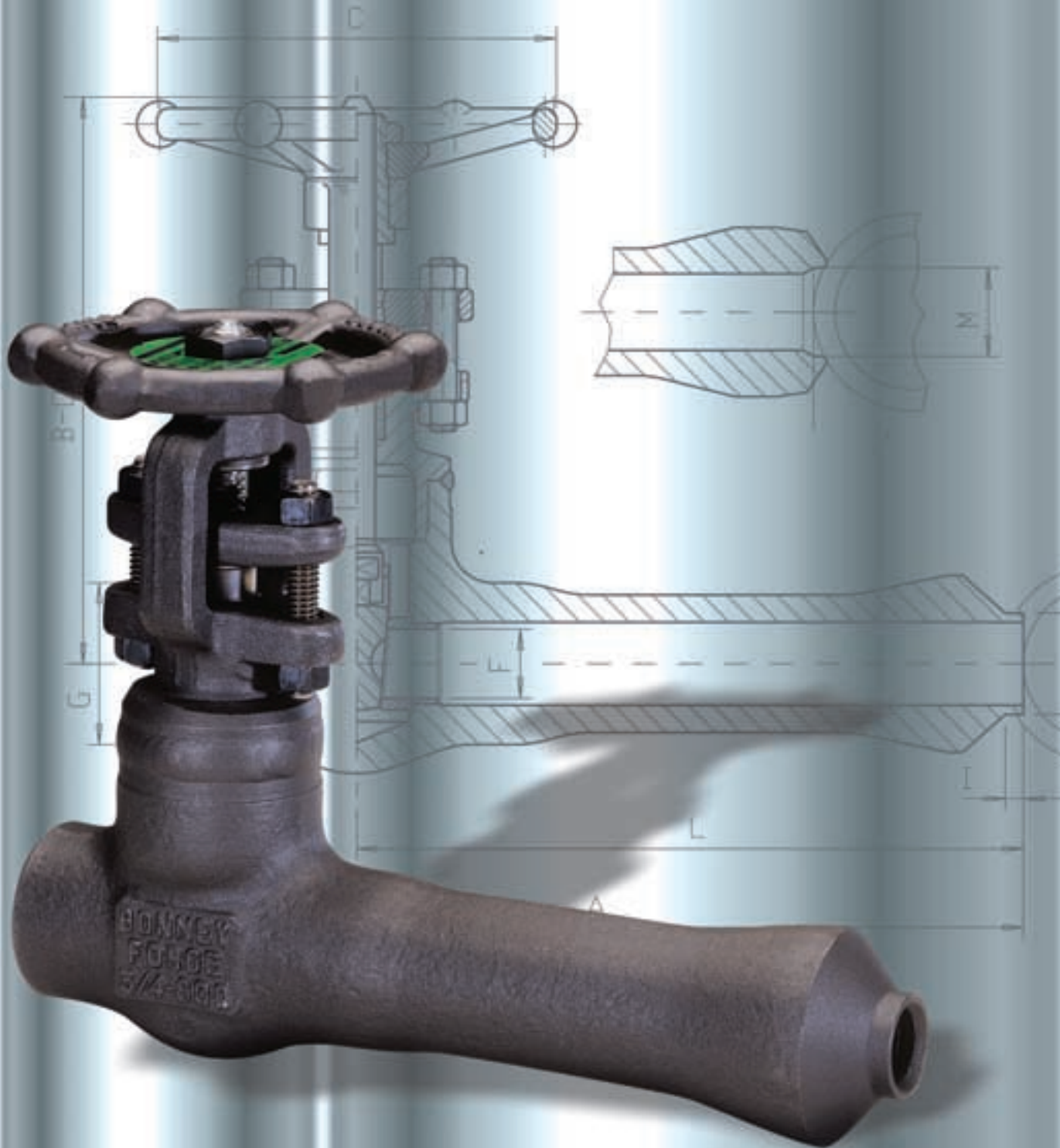

## VALV-O-LET

CLASS 800						
BOLTED BONNET - Type VL 100 / WELDED BONNET - Type VOL 100						
SIZE	inch mm	1/2	3/4	1	1.1/2	2
A		207	218,5	244,5	263,5	267,5
B open		152	158	196	255	290
C		88	88	97	138	138
F		9,6	14	18	30	36,6
G		32	38	48	64	78
L		167	173	190	200	204
M		22	30	36,5	50,5	65
W. kg $\equiv$ Bolted B.		2,6	3,1	5,1	9,5	13
W. kg $\equiv$ Welded B.		2,3	2,9	4,3	8,8	11,7
FIGURE Bolted B.		VL 103	VL 104	VL 105	VL 107	VL 108
FIGURE Welded B.		VOL 103	VOL 104	VOL 105	VOL 107	VOL 108
PACKING		BH2	BH2	BH4	BH6/A	BY5/A
GASKET*		G2	G2	G3	G6	G7

CLASS 1500						
BOLTED BONNET - Type 9VL 100 / WELDED BONNET - Type 9VOL 100						
SIZE	inch mm	1/2	3/4	1	1.1/2	2
A		218,5	244,5	263,5	263,5	267,5
B open		153	190	220	220	282
C		88	97	138	138	138
F		9,6	14	18	18	30
G		38	48	56	56	78
L		173	190	200	200	204
M		30	36,5	50,5	50,5	65
W. kg $\equiv$ Bolted B.		3,6	5,6	10,5	10,5	14,5
W. kg $\equiv$ Welded B.		2,9	4,7	9	9	12,5
FIGURE Bolted B.		9VL 103	9VL 104	9VL 105	9VL 105	9VL 107
FIGURE Welded B.		9VOL 103	9VOL 104	9VOL 105	9VOL 105	9VOL 107
PACKING		BH3	BH5	BH6/A	BH6/A	2B5
GASKET*		G1	G2	G3	G3	G5

## INTEGRAL REINFORCED

CLASS 800						
BOLTED BONNET - Type VLL 100 / WELDED BONNET - Type VOLL 100						
SIZE	inch mm	1/2	3/4	1	1.1/2	2
A		207	218,5	244,5	263,5	267,5
B open		152	158	196	255	290
C		88	88	97	138	138
F		9,6	14	18	30	36,6
G		32	38	48	64	78
H		17,5	22	28,5	41	46
I		4	4,8	4,8	6,3	8
L		167	173	190	200	204
W. kg $\equiv$ Bolted B.		2,6	3,1	5,1	9,5	13
W. kg $\equiv$ Welded B.		2,3	2,9	4,3	8,8	11,7
FIGURE Bolted B.		VLL 103	VLL 104	VLL 105	VLL 107	VLL 108
FIGURE Welded B.		VOLL 103	VOLL 104	VOLL 105	VOLL 107	VOLL 108
PACKING		BH2	BH2	BH4	BH6/A	BY5/A
GASKET*		G2	G2	G3	G6	G7

CLASS 1500						
BOLTED BONNET - Type 9VLL 100 / WELDED BONNET - Type 9VOLL 100						
SIZE	inch mm	1/2	3/4	1	1.1/2	2
A		218,5	244,5	263,5	263,5	267,5
B open		153	190	220	220	282
C		88	97	138	138	138
F		9,6	14	18	18	30
G		38	48	56	56	78
H		17,5	22	28,5	28,5	41
I		4	4,8	4,8	4,8	6,3
L		173	190	200	200	204
W. kg $\equiv$ Bolted B.		3,6	5,6	10,5	10,5	14,5
W. kg $\equiv$ Welded B.		2,9	4,7	9	9	12,5
FIGURE Bolted B.		9VLL 103	9VLL 104	9VLL 105	9VLL 105	9VLL 107
FIGURE Welded B.		9VOLL 103	9VOLL 104	9VOLL 105	9VOLL 105	9VOLL 107
PACKING		BH3	BH5	BH6/A	BH6/A	2B5
GASKET*		G1	G2	G3	G3	G5

\* Only for Bolted Bonnet type

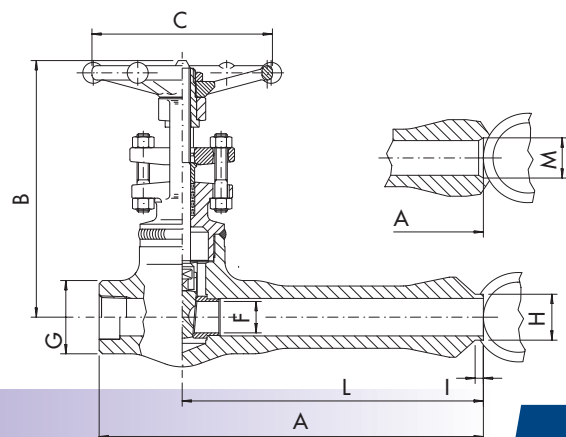
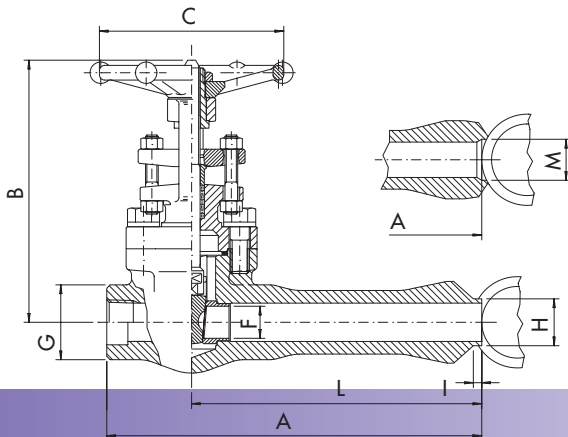

# EXTENDED BODY



Ratings:  
 - carbon steel class 800 1975 psig @ 100°F  
 138 bar + 38°C  
 - carbon steel class 1500 3705 psig @ 100°F  
 255 bar + 38°C

Socket weld Ends to ANSI B16.11  
 Screwed Ends (NPT) to ANSI B1.20.1  
 Butt Welding Ends to ANSI B.16.25  
 For special execution see special features  
 For materials and testing pressure see technical data

## SOCKET WELD

### CLASS 800

#### Type MLT 100 - MFLT 100

SIZE	inch mm	1/2	3/4	1	1.1/2	2
A		141,5	146,5	166	190,5	216
B open		152	156	196	256	290
C		88	88	97	138	138
F		9,6	14	18	30	36,6
G		32	38	48	64	78
H		21,3	26,7	33,4	48,3	60,3
I		13	16	21	34	42
L		102	102	111	127	153
W. kg ≅ Bolted B.		2,4	2,6	4,2	8,1	11,8
W. kg ≅ Welded B.		1,7	2,1	3,2	7,2	10,3
FIGURE Bolted B.		MLT 103	MLT 104	MLT 105	MLT 107	MLT 108
FIGURE Welded B.		MFLT 103	MFLT 104	MFLT 105	MFLT 107	MFLT 108
PACKING		BH2	BH2	BH4	BH6/A	BY5/A
GASKET*		G2	G2	G3	G6	G7

### CLASS 1500

#### Type 9MLT 100 - 9MFLT 100

SIZE	inch mm	1/2	3/4	1	1.1/2
A		146,5	166	190,5	216
B open		153	190	220	282
C		88	97	138	138
F		9,6	14	18	30
G		38	48	64	85
H		21,3	26,7	33,4	48,3
I		13	16	21	34
L		102	111	127	153
W. kg ≅ Bolted B.		2,6	4,6	9,1	13
W. kg ≅ Welded B.		2,1	3,8	8,1	12
FIGURE Bolted B.		9MLT 103	9MLT 104	9MLT 105	9MLT 107
FIGURE Welded B.		9MFLT 103	9MFLT 104	9MFLT 105	9MFLT 107
PACKING		BH3	BH5	BH6/A	2B5
GASKET*		G1	G2	G3	G5

## BEVELED END FOR WELDING

### CLASS 800

#### Type MLB 100 - MFLB 100

SIZE	inch mm	1/2	3/4	1	1.1/2	2
A		141,5	146,5	166	190,5	216
B open		152	156	196	256	290
C		88	88	97	138	138
F		9,6	14	18	30	36,6
G		32	38	48	64	78
I		13	16	21	34	42
L		102	102	111	127	153
N		23	28	36	52	62
W. kg ≅ Bolted B.		2,4	2,6	4,2	8,1	11,8
W. kg ≅ Welded B.		1,7	2,1	3,2	7,2	10,3
FIGURE Bolted B.		MLB 103	MLB 104	MLB 105	MLB 107	MLB 108
FIGURE Welded B.		MFLB 103	MFLB 104	MFLB 105	MFLB 107	MFLB 108
PACKING		BH2	BH2	BH4	BH6/A	BY5/A
GASKET*		G2	G2	G3	G6	G7

### CLASS 1500

#### Type 9MLB 100 - 9MFLB 100

SIZE	inch mm	1/2	3/4	1	1.1/2
A		146,5	166	190,5	216
B open		153	190	220	282
C		88	97	138	138
F		9,6	14	18	30
G		38	48	64	85
I		13	16	21	34
L		102	111	127	153
N		23	28	36	52
W. kg ≅ Bolted B.		2,6	4,6	9,1	13
W. kg ≅ Welded B.		2,1	3,8	8,1	12
FIGURE Bolted B.		9MLB 103	9MLB 104	9MLB 105	9MLB 107
FIGURE Welded B.		9MFLB 103	9MFLB 104	9MFLB 105	9MFLB 107
PACKING		BH3	BH5	BH6/A	2B5
GASKET*		G1	G2	G3	G5

\* Only for Bolted Bonnet type

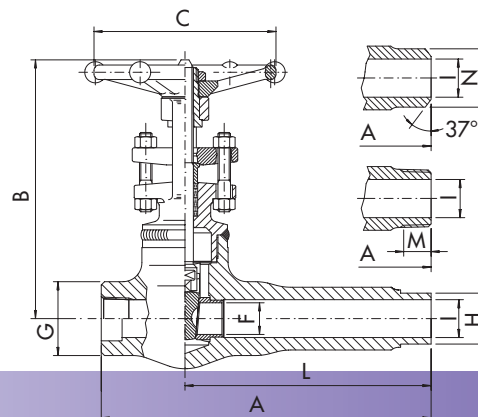
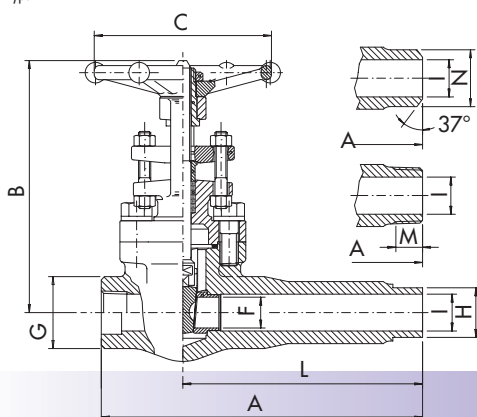

## EXTENDED BODY

## THREADED END

### CLASS 800

BOLTED BONNET - Type MLF 100						
SIZE	inch	1/2	3/4	1	1.1/2	2
	mm	15	20	25	40	50
A		141,5	146,5	166	190,5	216
B open		152	156	196	256	290
C		88	88	97	138	138
F		9,6	14	18	30	36,6
G		32	38	48	64	78
I		13	16	21	34	42
L		102	102	111	127	153
N		19	22	27	28	30
WEIGHT kg $\approx$		2,4	2,6	4,2	8,1	11,8
FIGURE		MLF 103	MLF 104	MLF 105	MLF 107	MLF 108
PACKING		BH2	BH2	BH4	BH6/A	BY5/A
GASKET		G2	G2	G3	G6	G7

WELDED BONNET - Type MFL 100						
SIZE	inch	1/2	3/4	1	1.1/2	2
	mm	15	20	25	40	50
A		141,5	146,5	166	190,5	216
B open		152	156	196	256	290
C		88	88	97	138	138
F		9,6	14	18	30	36,6
G		32	38	48	64	78
I		13	16	21	34	42
L		102	102	111	127	153
N		19	22	27	28	30
WEIGHT kg $\approx$		1,7	2,1	3,2	7,2	10,3
FIGURE		MFL 103	MFL 104	MFL 105	MFL 107	MFL 108
PACKING		BH2	BH2	BH4	BH6/A	BY5/A
GASKET						

### CLASS 1500

BOLTED BONNET - Type 9MLF 100					
SIZE	inch	1/2	3/4	1	1.1/2
	mm	15	20	25	40
A		146,5	166	190,5	216
B open		153	190	220	282
C		88	97	138	138
F		9,6	14	18	30
G		38	48	64	85
I		13	16	21	34
L		102	111	127	153
N		19	22	27	28
WEIGHT kg $\approx$		2,6	4,6	9,1	13
FIGURE		9MLF 103	9MLF 104	9MLF 105	9MLF 107
PACKING		BH3	BH5	BH6/A	2B5
GASKET		G1	G2	G3	G5

WELDED BONNET - Type 9MFL 100					
SIZE	inch	1/2	3/4	1	1.1/2
	mm	15	20	25	40
A		146,5	166	190,5	216
B open		153	190	220	282
C		88	97	138	138
F		9,6	14	18	30
G		38	48	64	85
I		13	16	21	34
L		102	111	127	153
N		19	22	27	28
WEIGHT kg $\approx$		2,1	3,8	8,1	12
FIGURE		9MFL 103	9MFL 104	9MFL 105	9MFL 107
PACKING		BH3	BH5	BH6/A	2B5
GASKET					

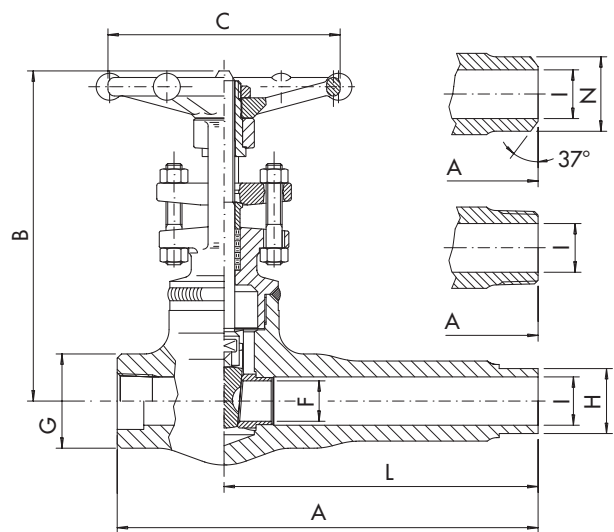
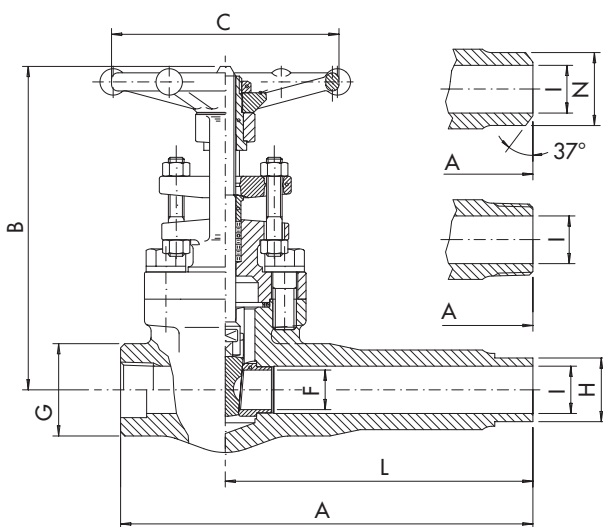

EXTENDED BODY

